

1108-1111&1121:

9mm	18mm
12mm	22mm
16mm	25mm

NECK SIZE:

60mm	77mm
65mm	90mm
70mm	101mm

UN-1103A



UN-1103B



UN-1104A



UN-1104B



UN-1105A



UN-1105A



UN-1106



UN-1107



UN-1108



UN-1109



UN-1110



UN-1111



UN-1112



UN-1113



UN-1114



UN-1115



UN-1116



UN-1117



UN-1118



UN-1119



UN-1120



UN-1121



UN-1122



UN-1123



UN-1124



UN-1125



UN-1126



UN-1127



UN-1128



UN-1129



## FEATURES

The sponge-pattern of air filter can endure the high temperature of 100o , with toughness, and is uneasy to deform. In order to maintain the efficiency of the air filter, the best method of maintaining performance is to replace regularly (each two years) a new air filter.



**NECK SIZE:**

60mm	70mm
65mm	77mm

**COLOR:**

Red		Yellow	
Blue		Green	

UN-1301A



UN-1301B



UN-1301C



UN-1304



UN-1303A



UN-1303B



UN-1305A



UN-1305B



UN-1306



SPONGE-01



SPONGE-02



SPONGE-03



SPONGE-04



UN-1307



UN-1308



UN-1309



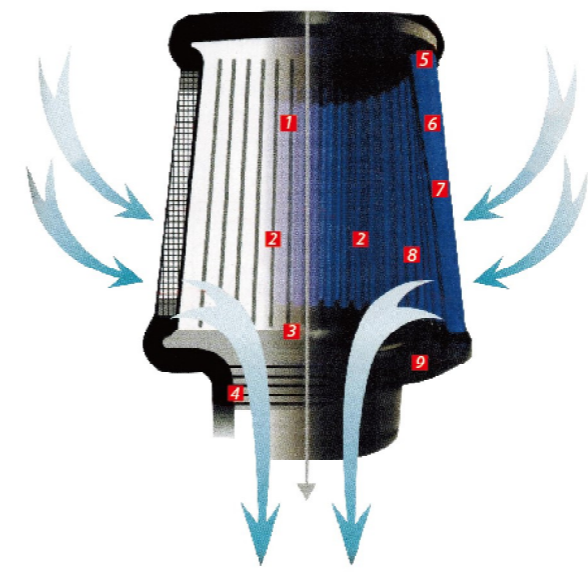

- 1 High Flow Filter Element With Filtration Proiction
- 2 Extreme Built-in Velocity Stack
- 3 High Grip Design For Perfect Fitment
- 4 Urethane Base Can Ensure The Temperature In The Engine By Heat Over 140 C
- 5 Light Urethane Top
- 6 Strong Galvanized Steel Mesh
- 7 Bright Epoxy Coating
- 8 Deep Pleats/3d Precision Weaving Technology Increases 20% Filtration Area
- 9 Urethane Base Is One-piece Formed, anti-vibration And Durable



**NECK SIZE:**

9mm	35mm
12mm	42mm
25mm	50mm

**NECK SIZE:**

65mm	90mm
70mm	101mm
77mm	152mm





UN-1607



UN-1608



UN-1609

**COLD AIR INTAKE SYSTEMS**

1. Available for the pipe inlets-65/70/77/80/85mm
2. Egr valve design
3. Designed by increasing volumetric efficiency
4. Increases power and performance
5. Inverted vector cone increases air flow to engine
6. Easy to install



UN-1610A



UN-1610B



UN-1610C



UN-1610A



UN-1611



UN-1613 BLUE



UN-1613 CARBON



UN-1613 RED



UN-1616 BLACK

**SUPER INLET  
 BIG TUBE**

Is specially designed for civic-series , effectively increasing the compressed air flow by its enlarged pipe.  
 Urethaeen top and base are durable.

**PE/CARBON**

equipped with urethane filter and high density PE intake pipe.

Item	Description	Years	Msrp
UN-1613	CIVIC EG	92-95	
	CIVIC EK	96-97	



UN-2117



**ALUMINUM INTAKE**

The additional installation of aluminum pipe for the components of this series not only can improve the horsepower, but also can make the whole vision more perfect.

**COLOR:** Red  Silver   
 Blue  Carbon 

ITEM NO	MODEL
2104	HONDACIVIC 96'-98'
2105	MISUBISHI II WIRA
2106	HONDACIVIC 01'-UFEX
2107	HONDACIVIC 99'-00'
2108	ACURAINTEGRAGSR 94'-01'
2109	HONDAACCORD EX 3 BEND 94'-97'
2110	MITSUBISHI JEEPV6
2111	MITSUBISHI JEEPV8
2112	HONDACIVIC DX/LX 96'-00'
2113	ACURAINTEGRALS/GS/RS 94'-01'
2114	MISUBISHI WIRA
2115	MISUBISHI WIRA
2116	TOYOTA
2117	KENALI/KELISA

UN-2104

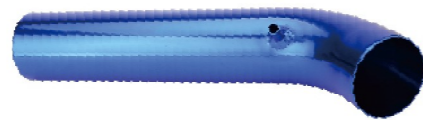

UN-2105



UN-2106



UN-2107



UN-2108



UN-2109



UN-2110



UN-2111



UN-2112

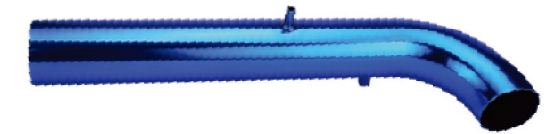

UN-2113

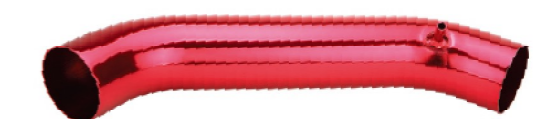

UN-2114



UN-2115



UN-2116

